

Elastic couplings with pins  
**PN** series, standard version

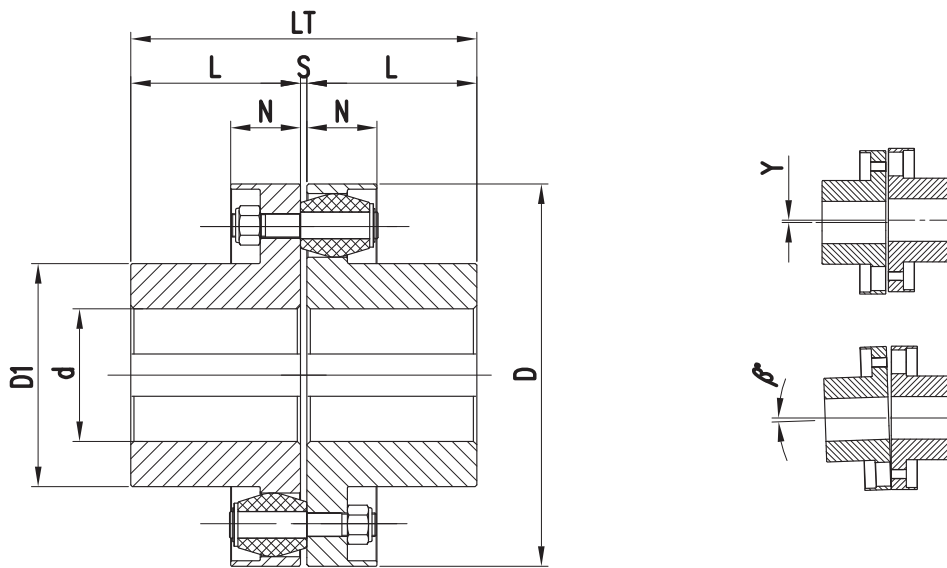

TYPE PN	TECHNICAL DATA				DIMENSIONS (mm)							No. Pins	WEIGHT (kg)	MISALIGNMENT (±)	
	$\frac{N}{n} = \frac{\text{kW}}{\text{rpm}}$	Mt (Nm)	Max speed (rpm)	PD <sup>2</sup> (kgm <sup>2</sup> )	d max	D	D1	L	N	S ± <sub>0</sub> <sup>2</sup>	LT			y(mm)	B(°)
60	0,0048	46	16000	0,0004	17	60	26	25	15	3	53	4	0,5	0,2	1°
70	0,0089	85	13700	0,0005	22	70	35	29	17		61	6	0,8		
80	0,0136	130	12000	0,0030	24	80	40	35	24		73	8	1,2		
90	0,0230	220	10600	0,0068	26	90	39	45	28	93	8	1,9			
100	0,0335	320	9500	0,0108	35	100	50	50	36	103	10	2,6			
112	0,0492	470	8500	0,0170	40	112	62	55	45	113	12	4,0			
125	0,0848	810	7680	0,0318	45	125	65	60	6	126	12	5,3			
140	0,116	1110	6800	0,055	55	140	80	70	6	146	14	8,0			
160	0,147	1400	6000	0,108	60	160	85	80	6	166	12	11,5			
180	0,198	1890	5300	0,191	70	180	104	90	6	186	14	17			
200	0,226	2160	4800	0,329	75	200	106	100	45	206	12	23			
225	0,304	2900	4260	0,575	90	225	128	110	6	226	14	32			
250	0,503	4800	3840	0,948	95	250	130	120	54	250	12	41			
280	0,681	6500	3400	1,60	115	280	158	130	10	270	14	58			
320	0,959	9160	3000	2,94	125	320	172	140	66	290	12	81			
360	1,298	12400	2700	5,21	150	360	210	160	14	330	14	122			
400	1,466	14000	2400	8,36	160	400	224	180	80	374	12	165			
450	1,999	19000	2160	15,9	190	450	265	200	14	414	14	310			
501	2,617	25000	1920	26,4	200	500	280	220	120	454	16	330			
560	5,424	51800	1740	50,8	210	560	295	240	14	494	12	450			
630	7,330	70000	1560	80,5	250	630	360	260	135	534	14	650			
710	10,26	98000	1400	148,6	290	710	400	280	150	574	14	910			
800	13,61	130000	1200	192,2	310	800	430	300	18	614	16	1160			
900	18,32	175000	1080	438	330	900	460	320	18	658	16	1530			
1000	23,56	225000	960	697	360	1000	500	350	18	718	18	1950			
1120	29,95	286000	900	1081	400	1120	560	380	18	778	20	2530			
1250	37,49	358000	800	1676	440	1250	610	420	18	858	22	3270			

The Weight and the PD<sup>2</sup> are calculated considering coupling with pilot bores.  
 For the machining of the finished bores it is necessary to specify diameters and keyways with tolerances.  
 On request is possible to have one or both hubs with different lengths.